

Temperature Compensated Crystal Oscillators

SXO-6000D SERIES (TTL / CMOS LOGIC)

STANDARD SMD TCXO

SXO-6000D(B)

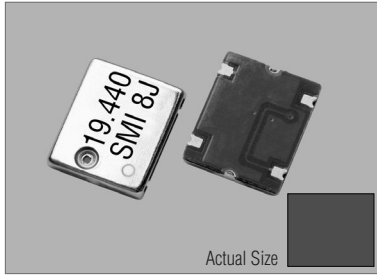

SXO-6000D(C)

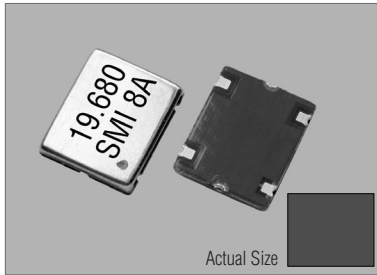

SXO-6000D(B)

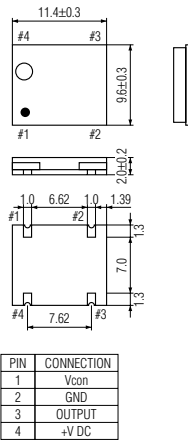

SXO-6000D(C)

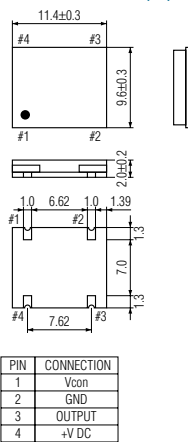

STANDARD SPECIFICATIONS

TTL/CMOS

Item	Specifications	
	SXO-6000D(B)	SXO-6000D(C)
Generic part number	SXO-6000D(B)	SXO-6000D(C)
Frequency range	10.000000 MHz to 40.000000 MHz	
Initial frequency tolerance	±0.5 ppm max. (Vcon = 1/2VDD DC at +25°C ±2°C)	±1.5 ppm max. at +25°C ±2°C (Vcon = 1/2VDD DC at +25°C ±2°C)
Frequency stability	BB/g/hh : ±1.0 ppm over -10°C to +65°C (referred to +25°C) CC/i/ii : ±1.5 ppm over -20°C to +70°C (referred to +25°C) EE/k/jj : ±2.5 ppm over -30°C to +75°C (referred to +25°C) JJ/m/ll : ±5.0 ppm over -40°C to +85°C (referred to +25°C)	
Temperature range	Input voltage change Aging ±0.3 ppm max. at VDD ±5% DC ±1.0 ppm max. / year at +25°C ±3°C	
Absolute Max. Ratings	Supply voltage Control voltage (Vcon) Storage temperature 0V to +7.0V 0V to VDD +0.6V -40°C to +85°C	
Operating Conditions	Operating temperature g/hh : -10°C to +65°C i/ii : -20°C to +70°C k/jj : -30°C to +75°C m/ll : -40°C to +85°C J = +3.0V, K = +3.3V, N = +5V DC ±5% 1/2VDD ±1V DC (VDD = +3.0V or +3.3V) 1/2VDD ±2V DC (VDD = +5V)	
Input voltage (VDD)	Input current 25 mA max.	
Control voltage (Vcon)	Output Level Load TTL / CMOS 2TTL / 15 pF (CMOS)	
Frequency Adjustment	Voltage control Frequency slope Internal trimmer ±5 ppm to ±15 ppm (Vcon = 1/2VDD ±1V or 1/2VDD ±2V) Positive ±3 ppm min. n.a.	
Startup time	10 ms max.	
IR reflow resistance	±1.0 ppm max.	
Reflow condition	+25°C ±10°C for 10 seconds	
Standard frequencies (MHz)	10.000000 12.000000 12.800000 15.000000 16.800000 19.200000 20.000000	

PACKAGE DATA

Item	Package	SXO-6000D(B)	SXO-6000D(C)
Cover		Metal	Metal
Base		PCB	PCB
Terminal		NiAu	NiAu
Terminal plating		Gold	Gold
RoHS		Compliant (Pb-free)	Compliant (Pb-free)

SOLDERING PATTERN

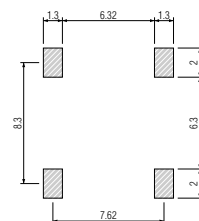

TAPE SPECIFICATIONS

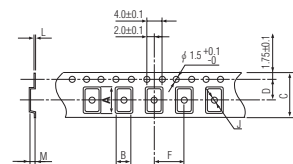

A	B	C	D	F	J	L	M	Reel Dia.	Qty/Reel
12.0	10.2	24.0	11.5	12.0	2.0	0.3	2.3	330 (300)	2000pcs

TCXO