

DETAILS

Product Number	CN13131_MIRELLA-50-M-DL-PF
Family	Mirella
Type	RefPack
Color	metal
Diameter	49,9 mm
Height	25,5 mm
Style	round
Optic Material	PC
Holder Material	PC
Fastening	screw, glue
Status	production ready
ROHS Compliant	Yes
Date Updated	21/04/2016



OPTICAL PROPERTIES

LED	Viewing	Light	Effi-		Connector
	Angle	Beam	ciency	cd/lm	
Soleriq S9	sim: 32	Medium	sim: 85 %	sim: 2.100	LEDiL: LEDiL
MK-R	23 deg	Medium	80 %	2.600	-
XHP50	24 deg	Medium	84 %	2.500	-
CLU700	24 deg	Medium	81 %	2.500	-
CLL01x	28 deg	Medium	86 %	2.300	-
XHP70	28 deg	Medium	82 %	2.200	-
COB 4W	29 deg	Medium	85 %	2.400	-
MHD-E/G	29 deg	Medium	86 %	2.000	-
Mini Zenigata (GW6BM)	30 deg	Medium	83 %	1.900	-
CLL02x/CLU02x (LES10)	31 deg	Medium	87 %	2.300	-
Duris S10	31 deg	Medium	80 %	1.900	LEDiL: LEDiL
MT-G2	32 deg	Medium	86 %	2.000	-
ZC4/6	32 deg	Medium	83 %	2.100	-
CXM-9	35 deg	Medium	84 %	1.700	-
MT-G	36 deg	Medium	87 %	1.900	-

Relative intensity of CN13131_MIRELLA-50-M-DL-PF-(CLL010)

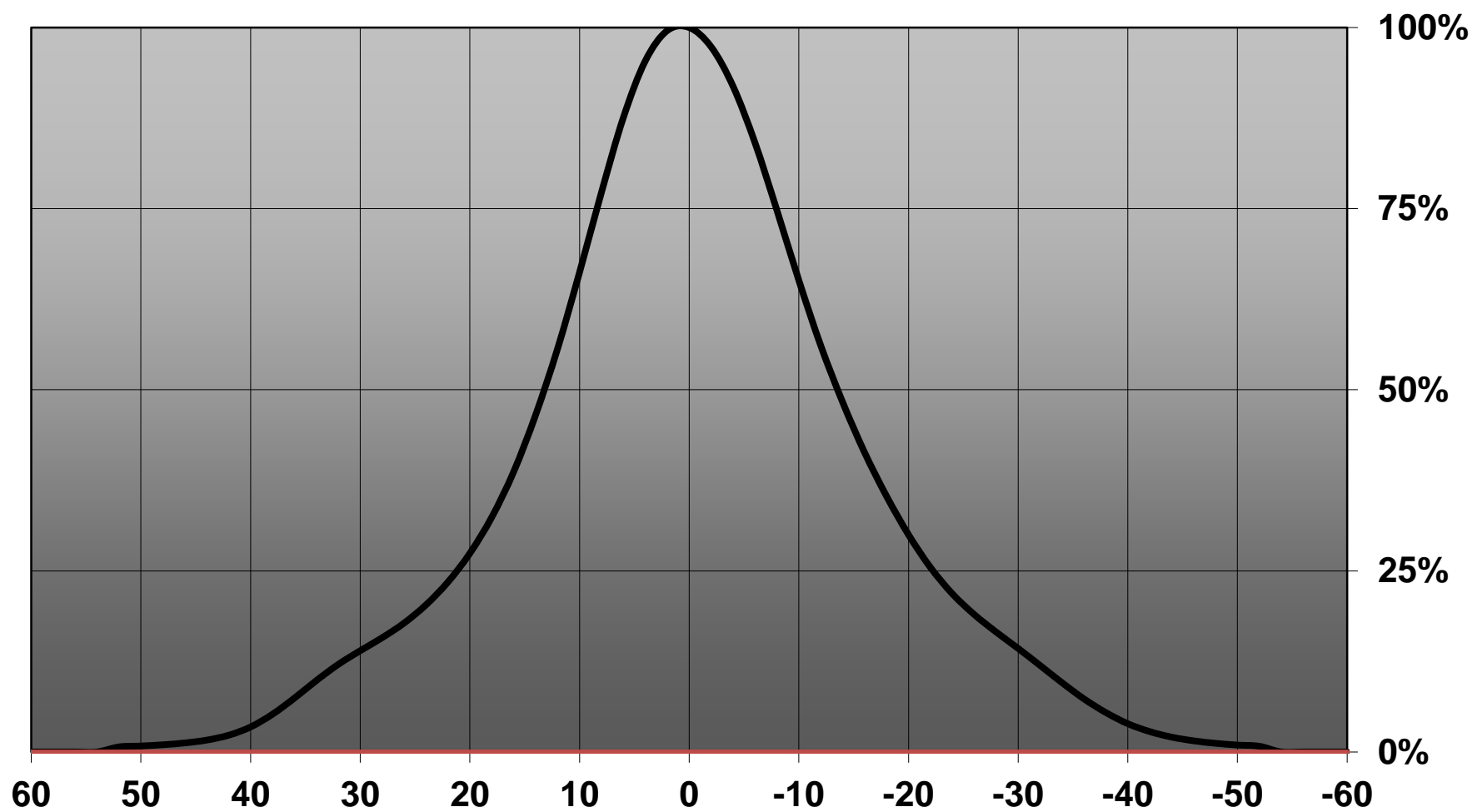

Relative intensity of Mirella-M-DL-4WLG

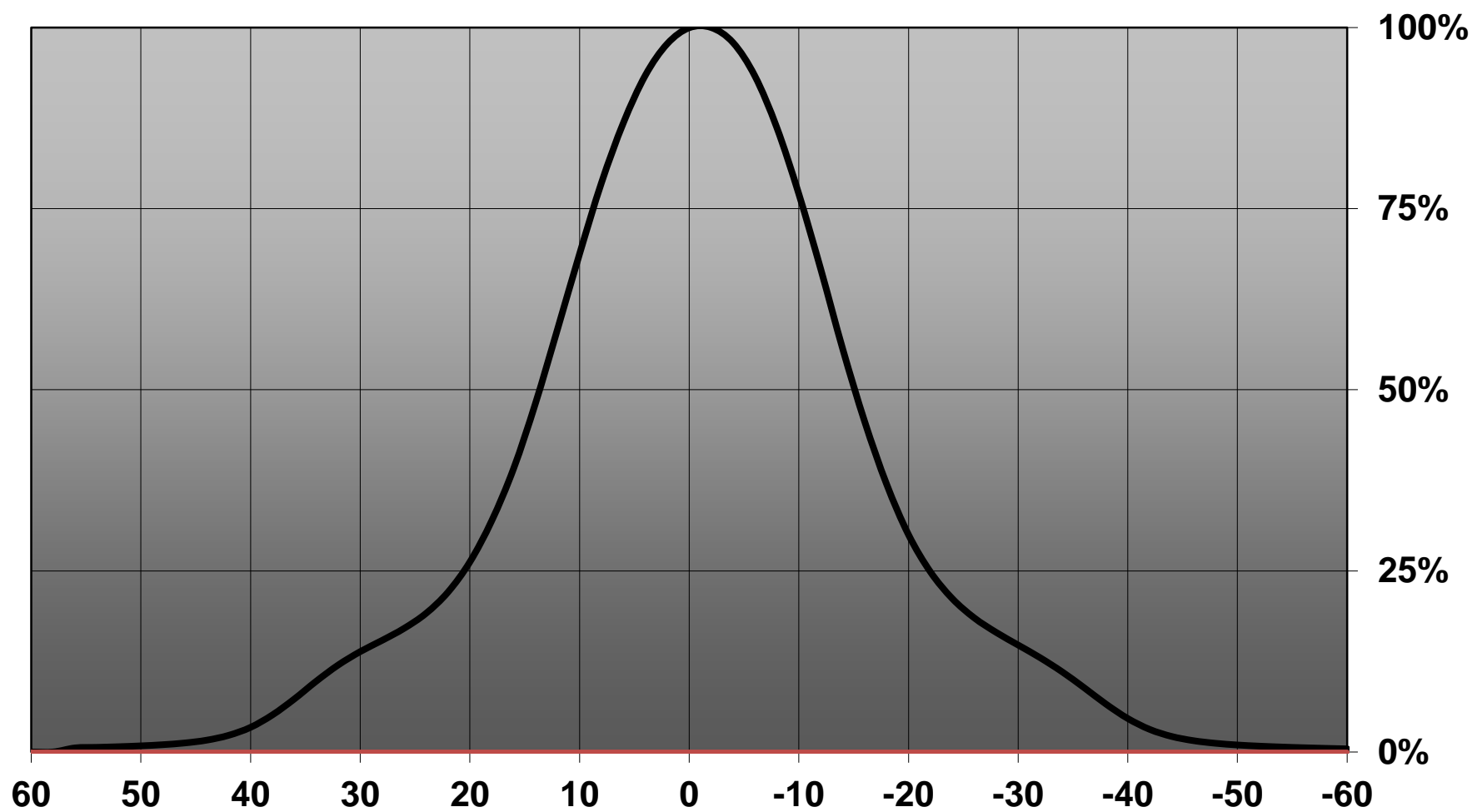

Relative intensity of CN13131_MIRELLA-50-M-DL-PF-(CLL020)

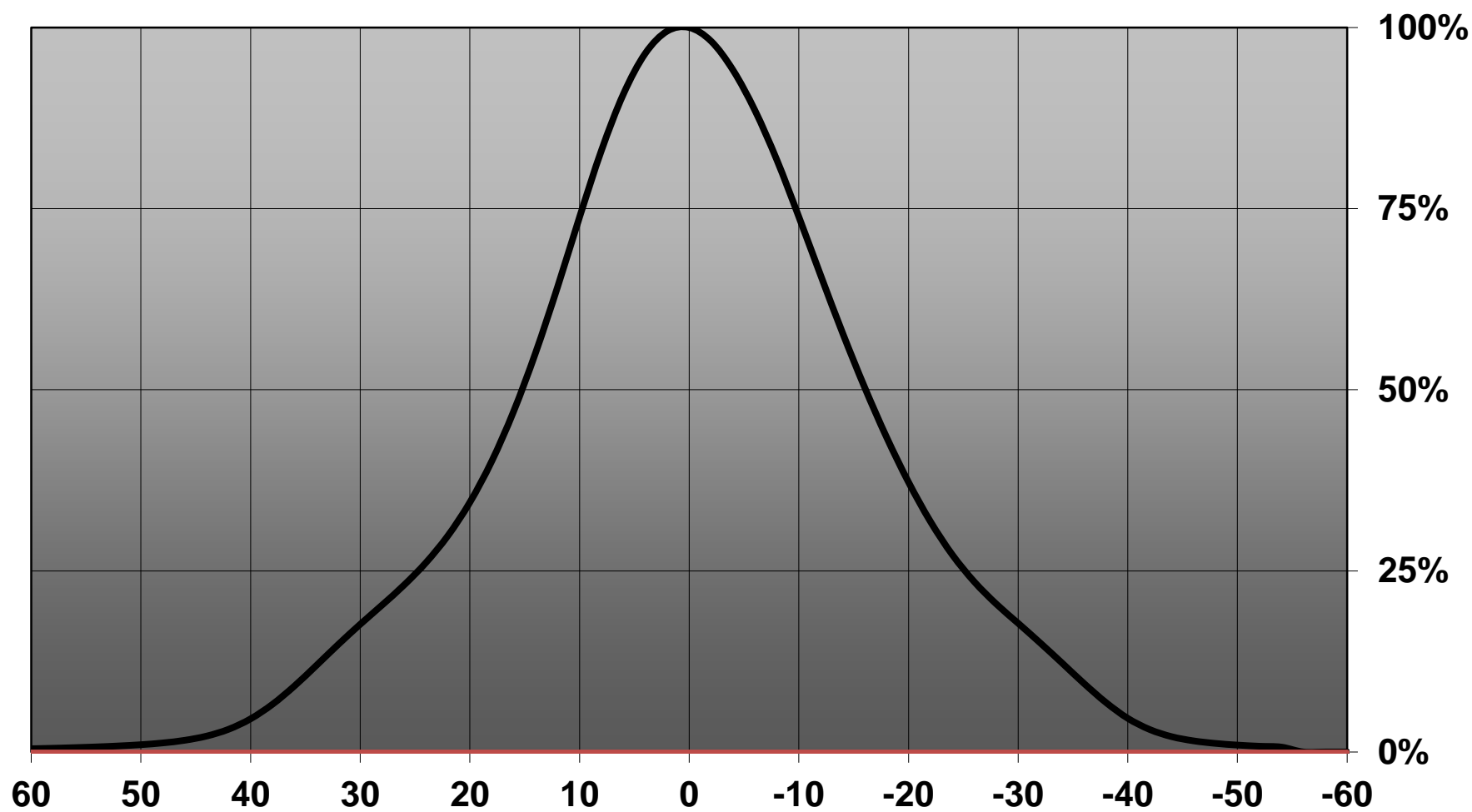

Relative intensity of CN13131_MIRELLA-50-M-DL-PF_(Duris_S10)

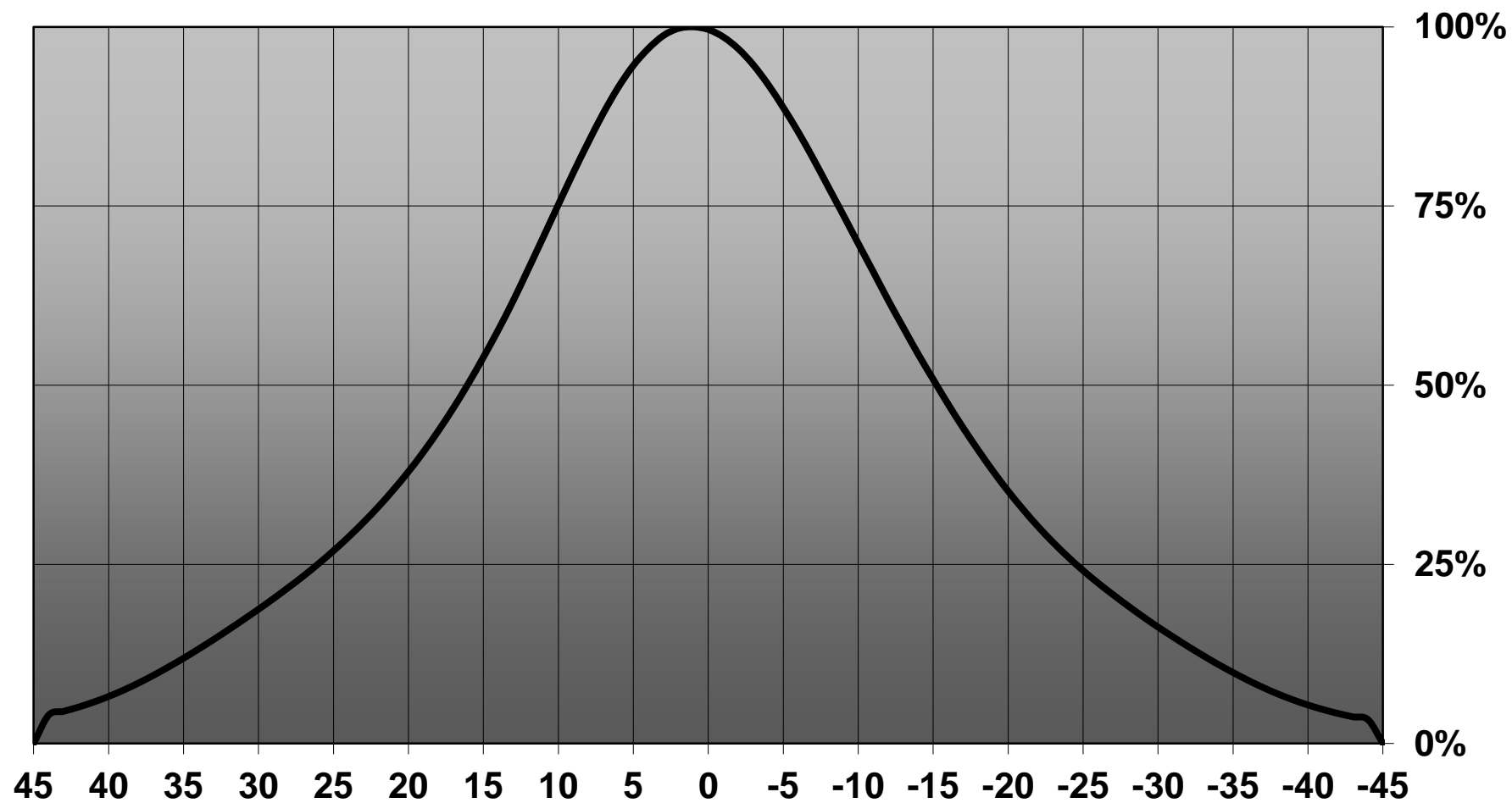

Relative intensity of CN13131_MIRELLA-50-M-DL-PF-(MTG2)

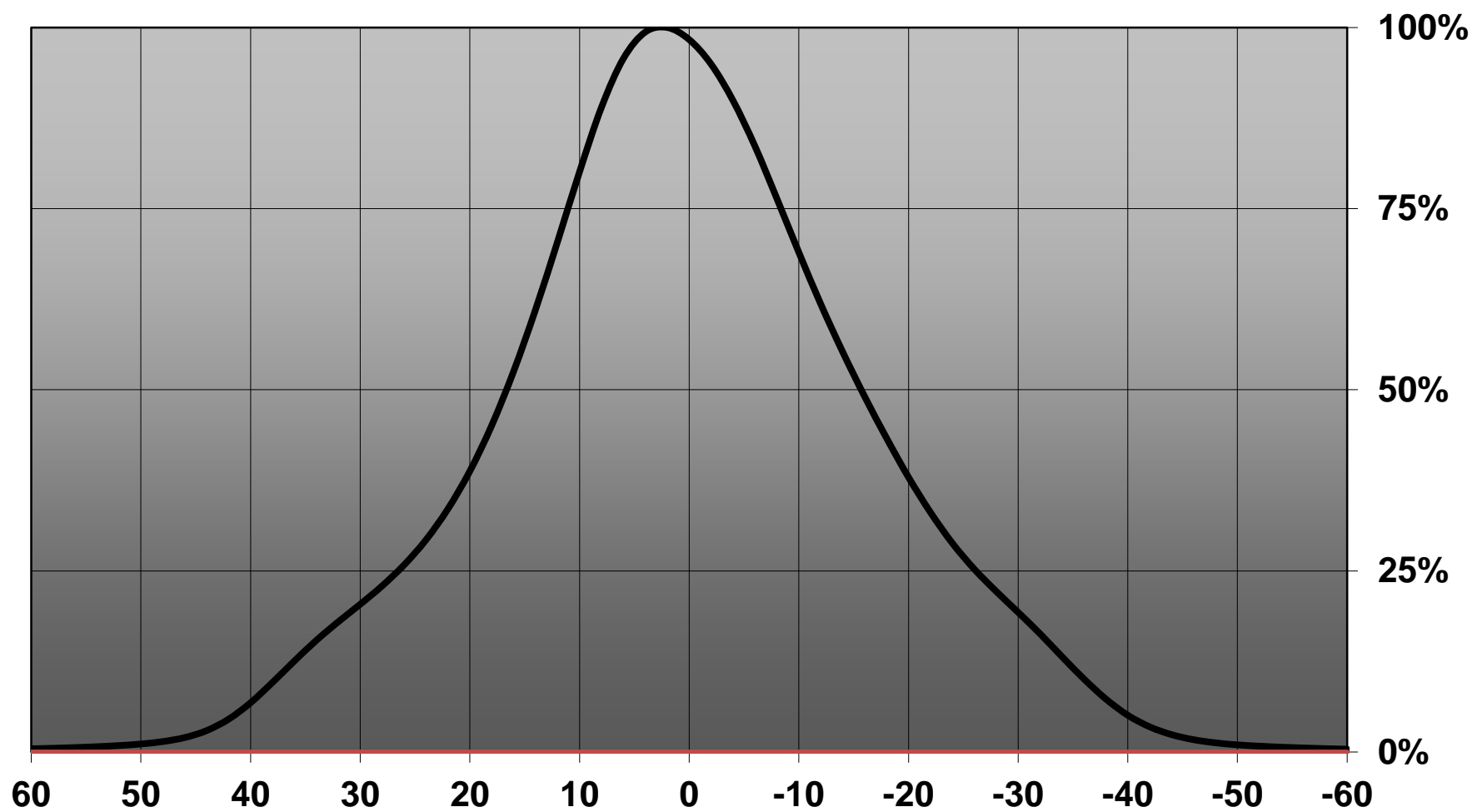

Relative intensity of CN13131_MIRELLA-50-M-DL-PF-(MTG)

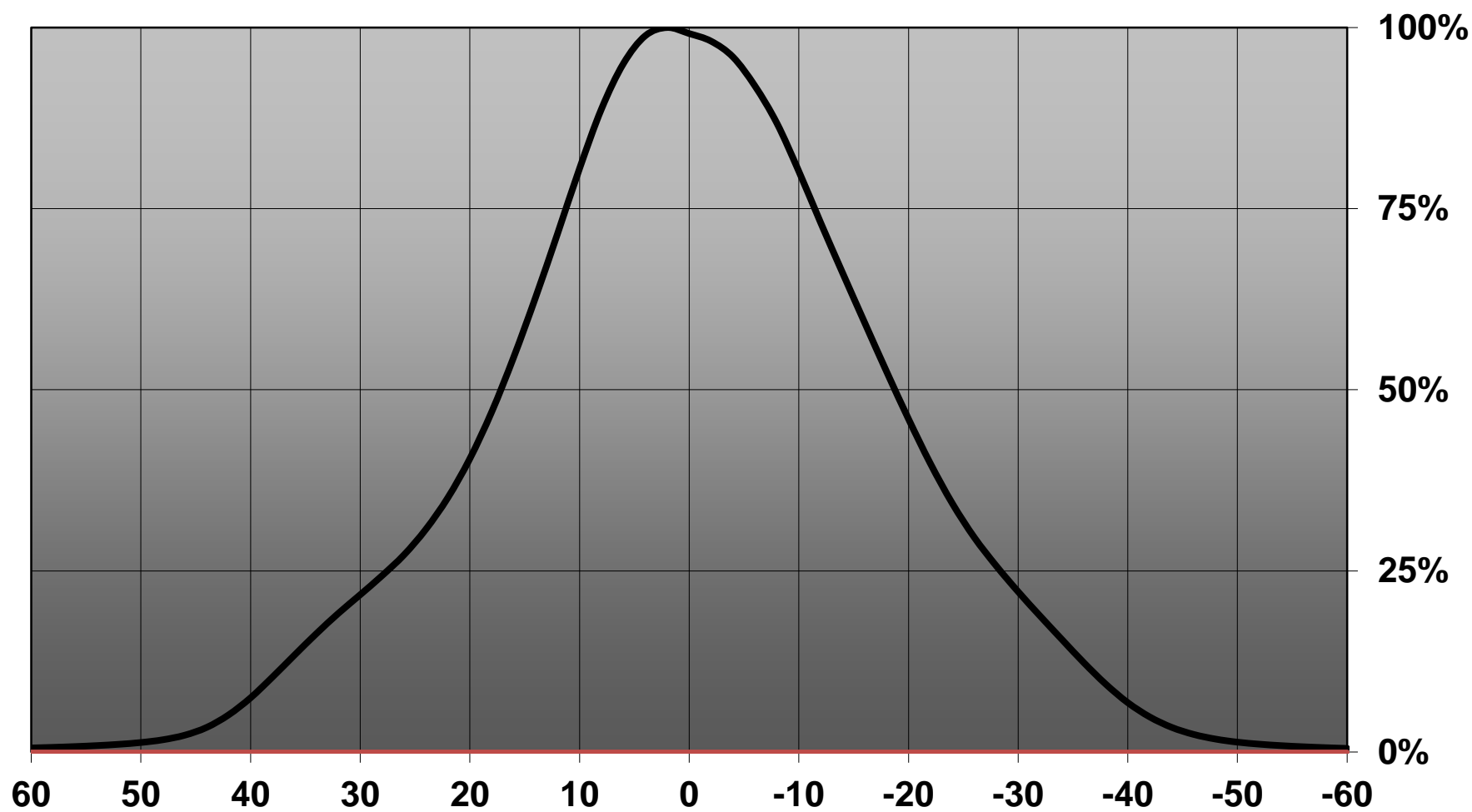

D

C

B

A

4

4

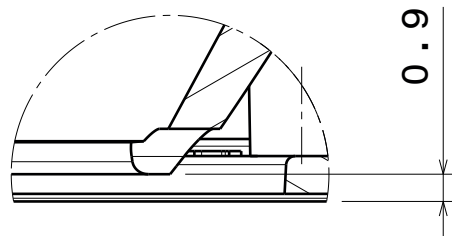
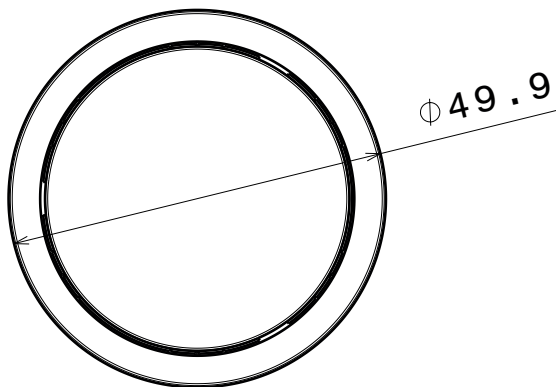
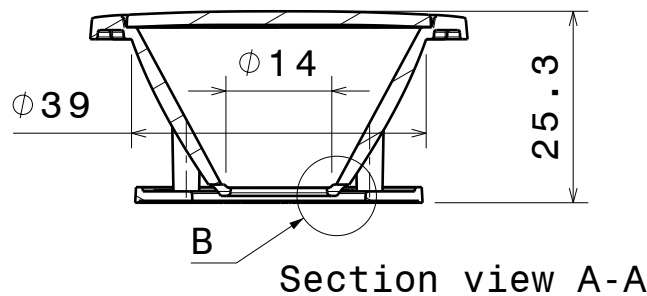
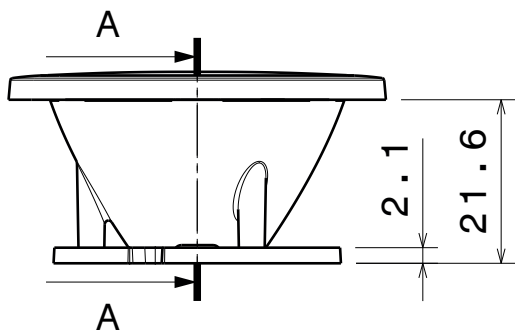
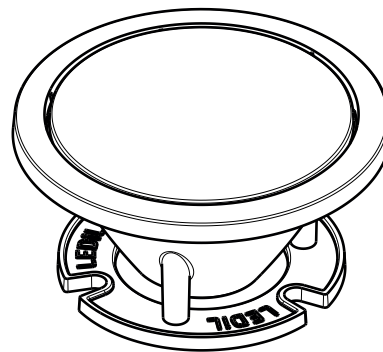
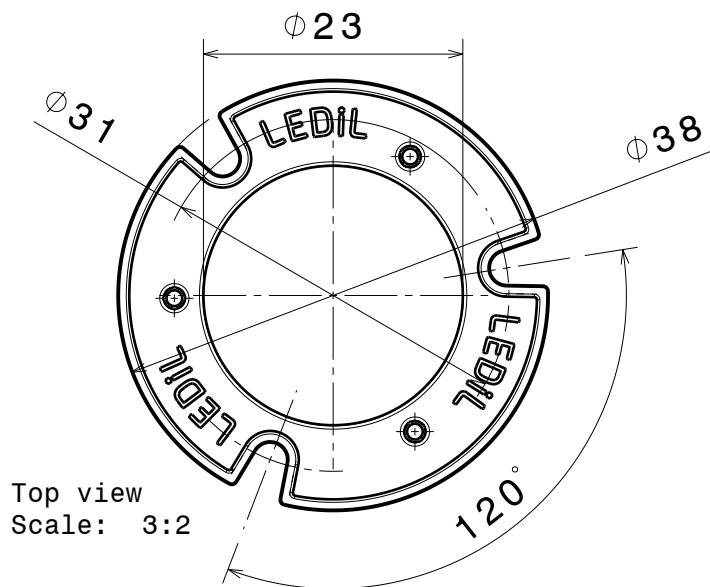

NOTE: It is recommended to use glue like DELO-PUR 9895 for pin fastening.
[http://www.delo.de/fileadmin/datasheet/DELO-PUR_9895_\(TIDB-GB\).pdf](http://www.delo.de/fileadmin/datasheet/DELO-PUR_9895_(TIDB-GB).pdf)

This drawing is our property.
 It can't be reproduced
 or communicated without
 our written agreement.

LEDIL

Ledil Oy
 Salorankatu 10
 FIN 24240 SALO
 Finland

DRAWN BY

as

DATE

28.8.2012

DRAWING TITLE

Mechanical drawing

CHECKED BY

VS

DATE

28.8.2012

SIZE

A4

REV

001

DESIGNED BY

as

DATE

SCALE

1:1

WEIGHT

-

SHEET

1/1

D

A

1

Luminaire: Ledil Oy CN13131_MIRELLA-50-M-DL-PF_(Soleriq_S9)_SIMULATED
Lamps: 1 x Osram Soleriq S9 (GW KAJFB3.EM)

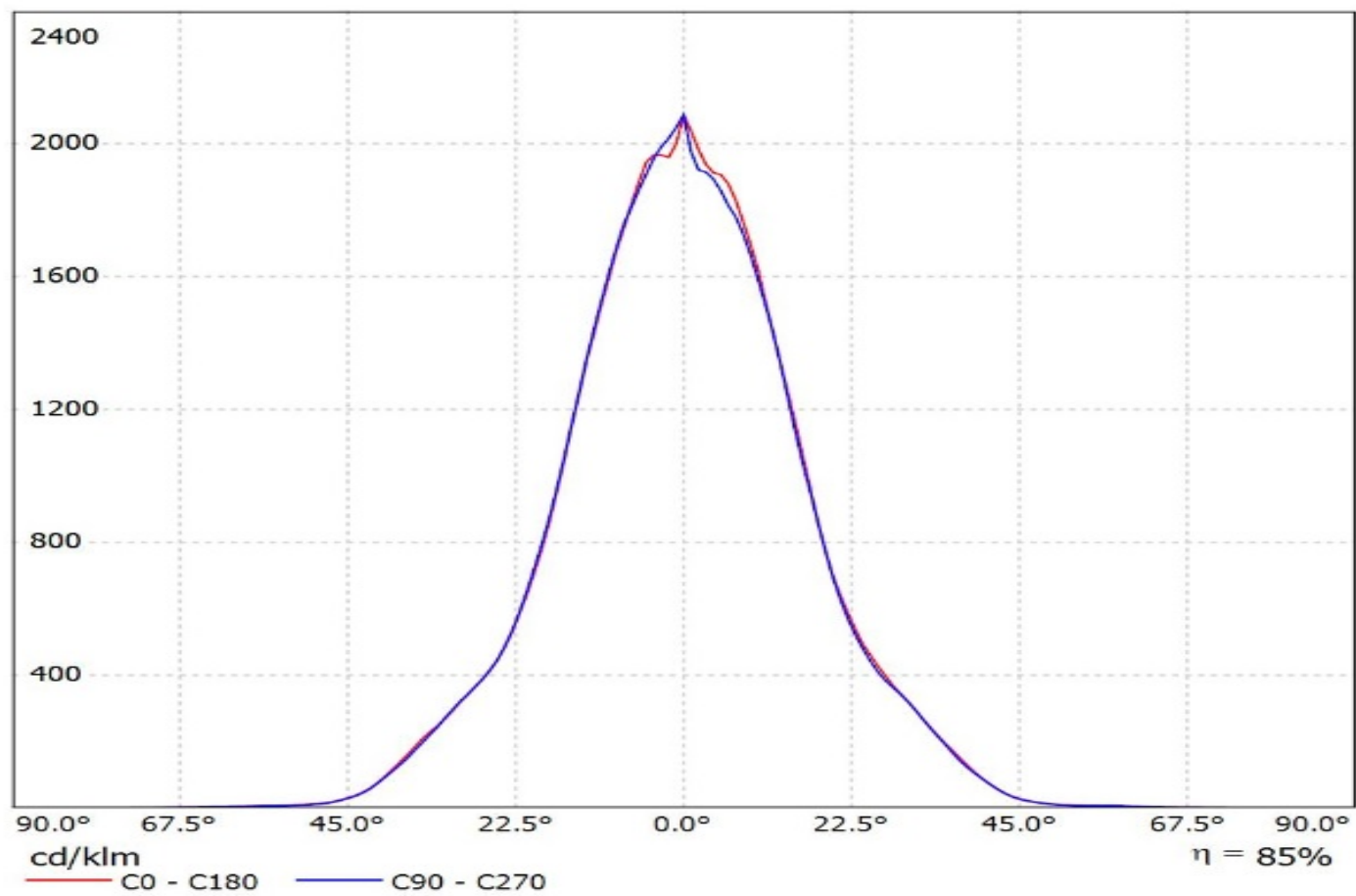

Luminaire: LEDiL Oy CN13131_MIRELLA-50-M-DL-PF_(MK-R) Eff 80.2%
Lamps: 1 x CREE_MK-R_358.348lm@250mA_P=2.84311W_I=249.9mA

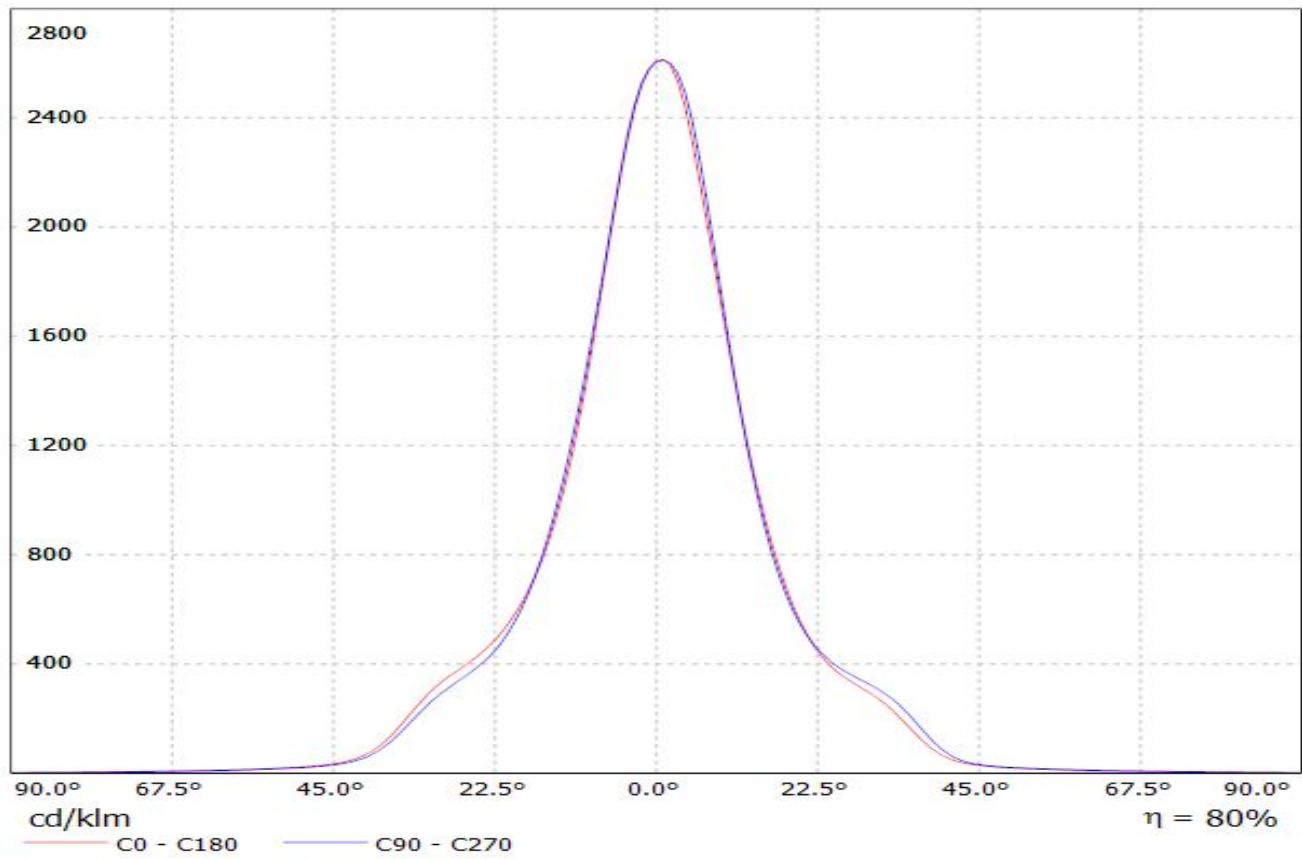

Luminaire: LEDiL Oy CN13131_MIRELLA-50-M-DL-PF_(CREE_XHP50_WARM_WHITE)
Lamps: 1 x CREE_XHP50_WARM_WHITE_194.142lm@250mA_P=1.39939W_I=0.2499A

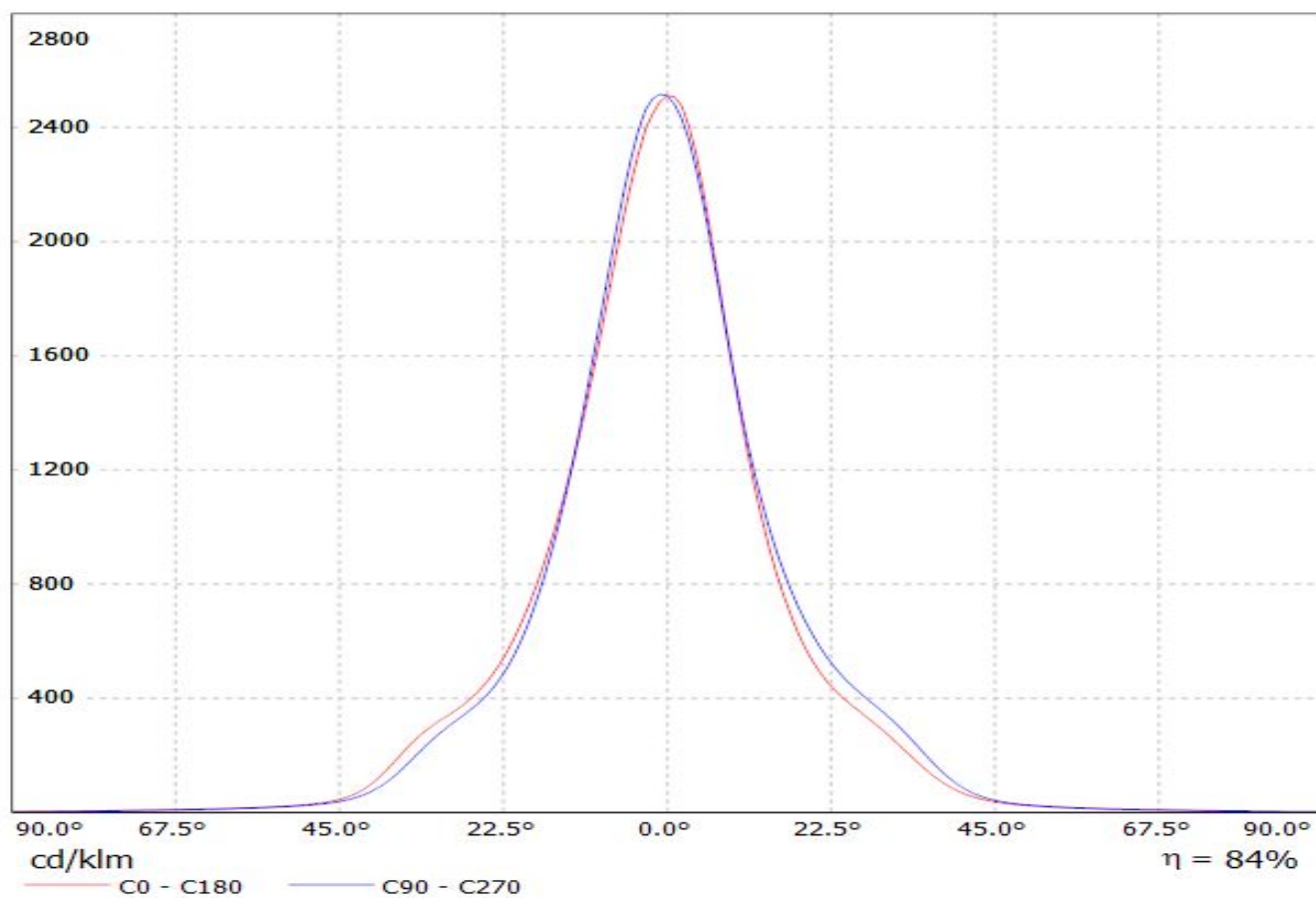

Luminaire: LEDiL Oy CN13131_MIRELLA-50-M-DL-PF_(CLU700)

Lamps: 1 x Citizen_CLU700_C13083_PF-SOCKET_394.785lm@100mA_P=2.92999W_I=0.1044A

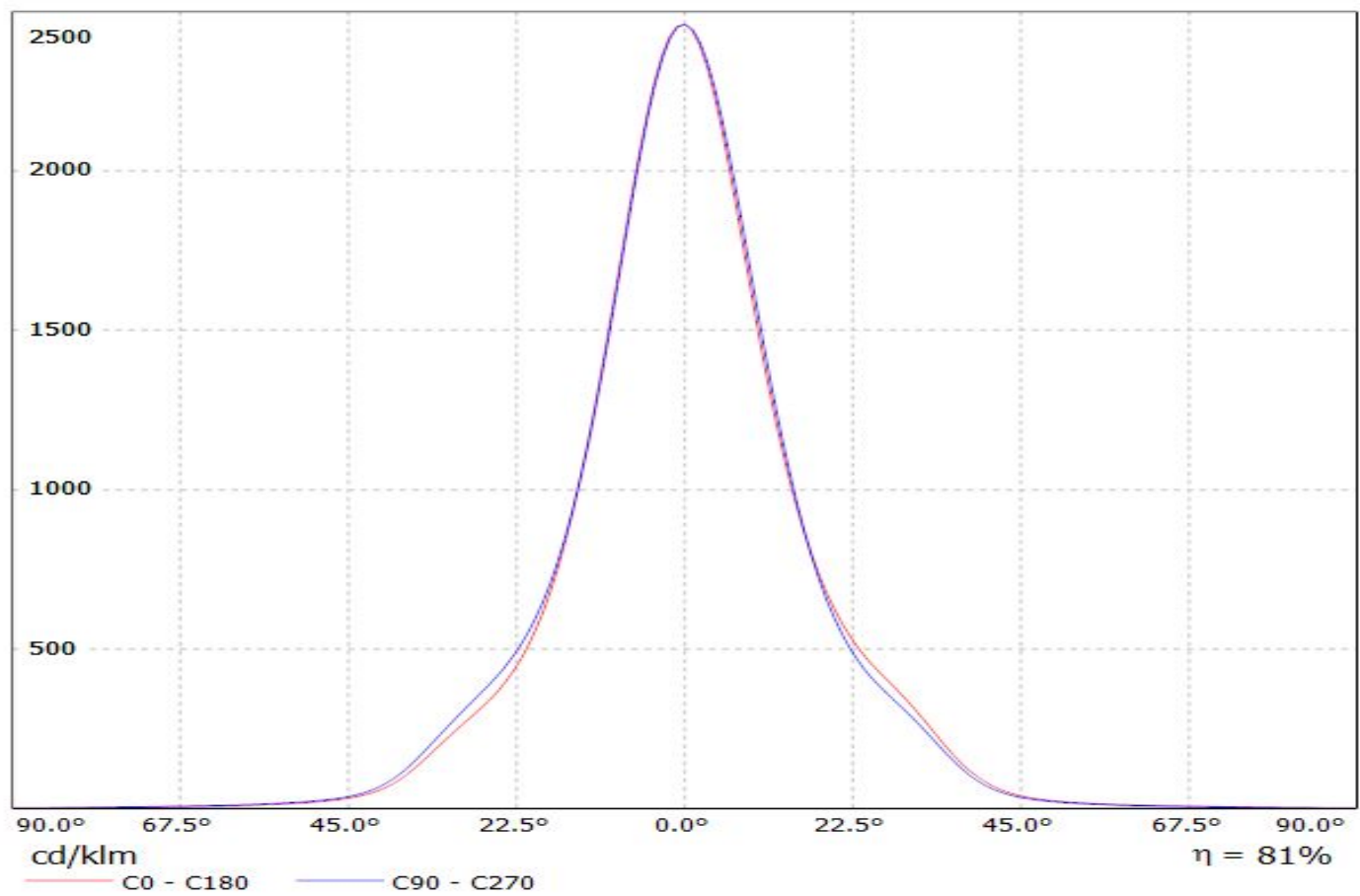

Luminaire: LEDiL Oy CN13131_MIRELLA-50-M-DL-PF_(CREE_XHP70)
Lamps: 1 x CREE_XHP70_260.212lm@250mA_P=1.383W_I=0.2499A

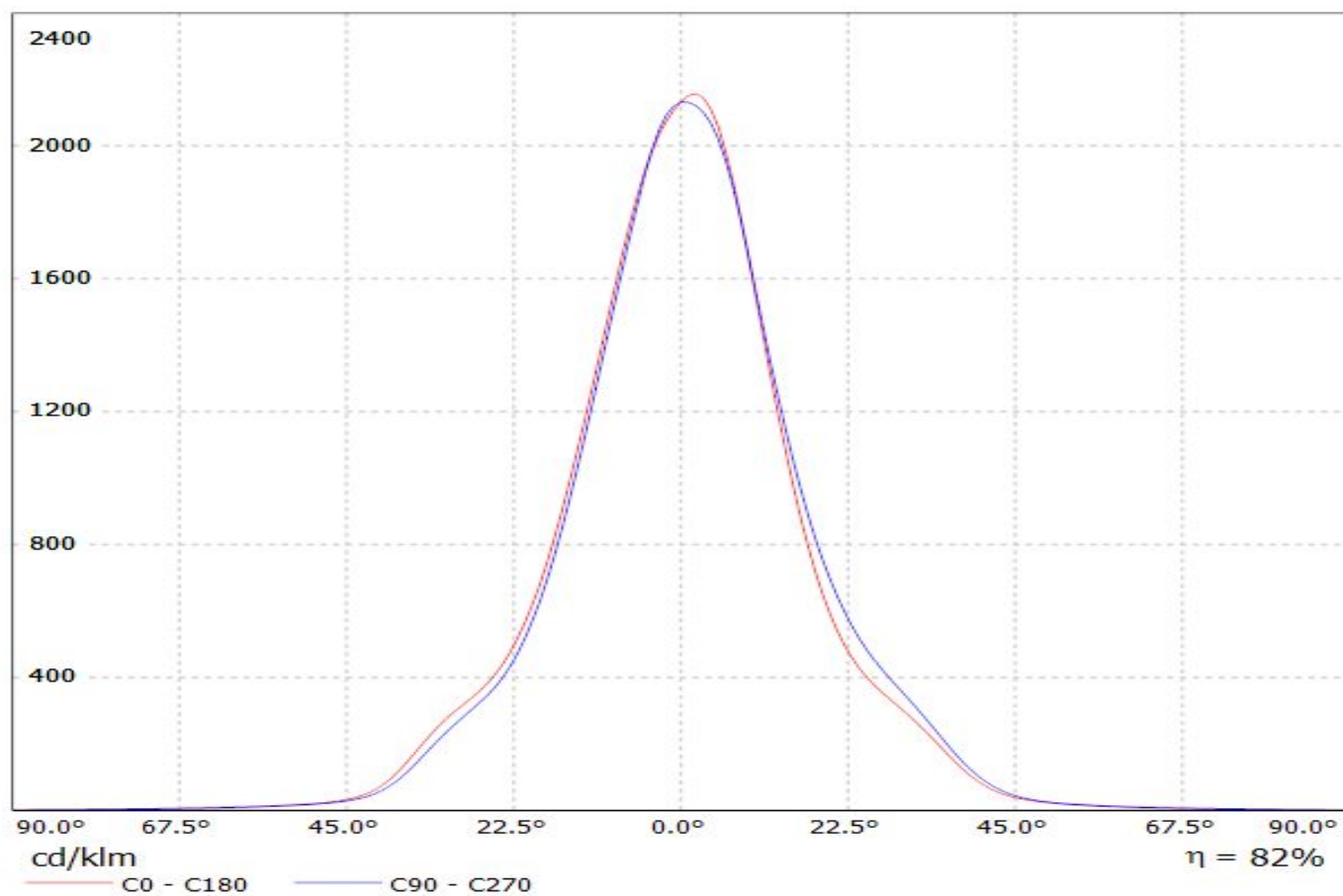

Luminaire: Ledil CN13131_MIRELLA-50-M-DL-PF_(MHD-G)
Lamps: 1 x Cree MHD-G_530.44lm@100mA_P=3.0W_I=0.100A

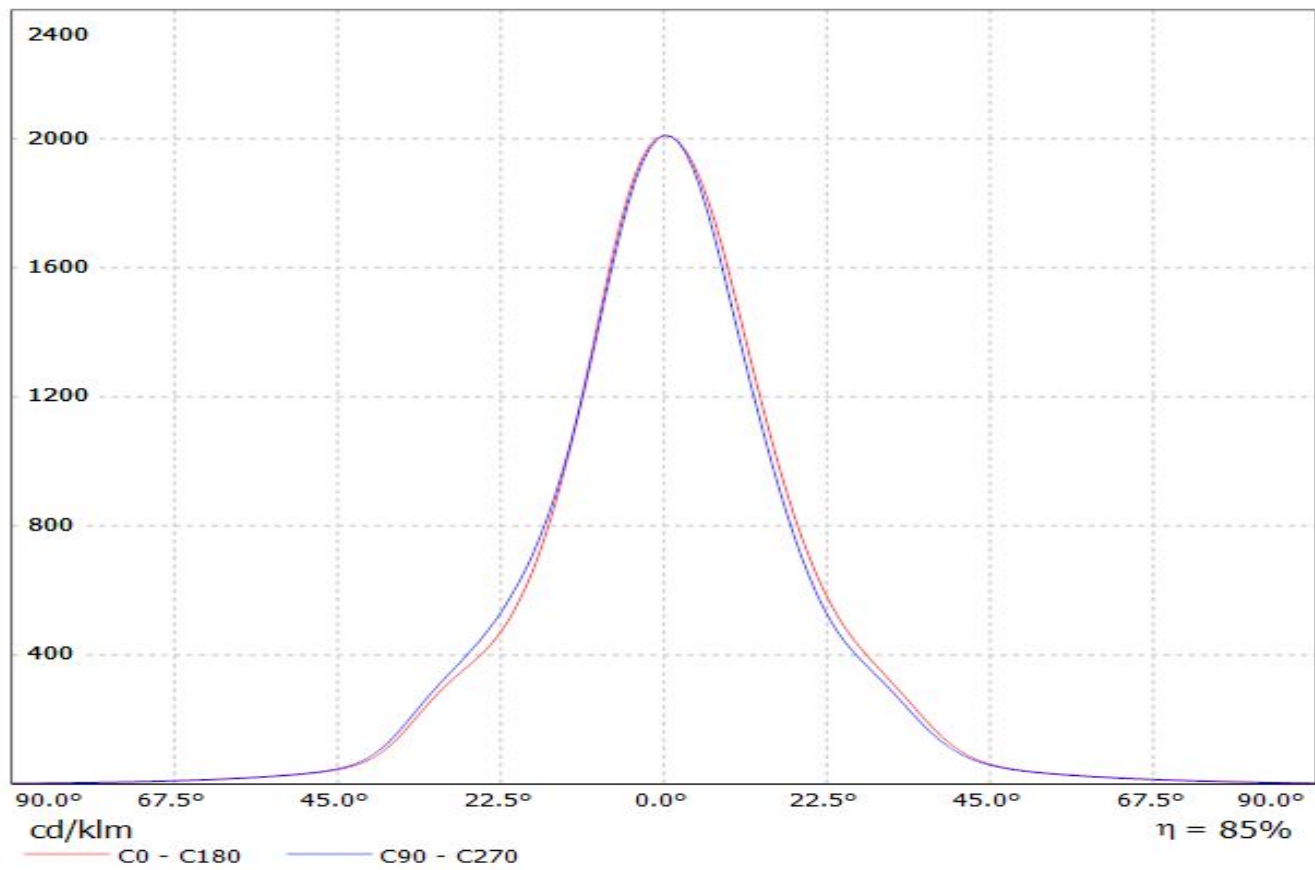

Luminaire: LEDiL Oy CN13131_MIRELLA-50-M-DL-PF_(Mini_Zenigata_GW6BM) Eff.83.3%
Lamps: 1 x Mini_Zenigata_GW6BM (803.772lm@250mA)

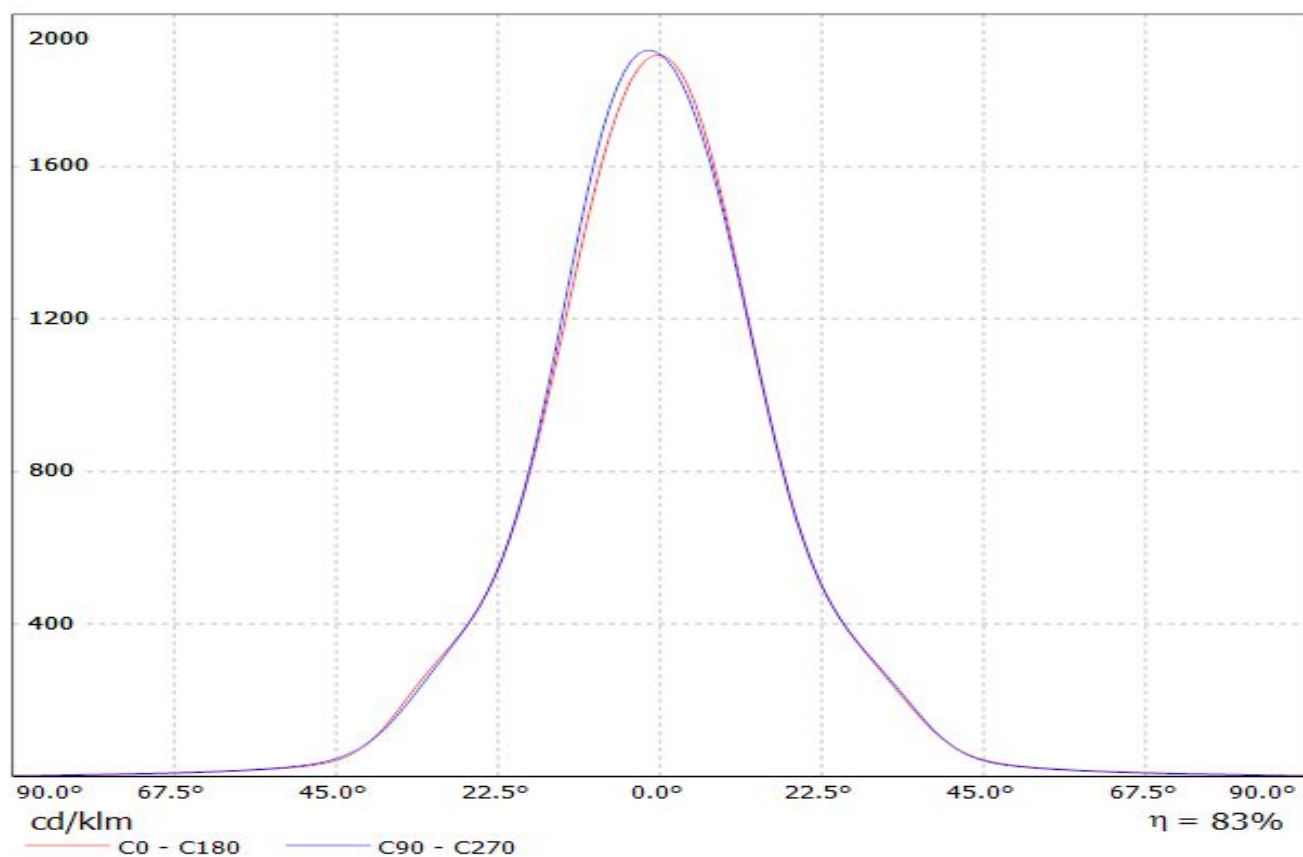

Luminaire: LEDil Oy CN13131_MIRELLA-50-M-DL-PF_(ZC6) Efficiency=83%
Lamps: 1 x Seoul ZC6 (SDW81F1C) 422lm @ 100mA CCT=3100K P=3.4W I=100mA

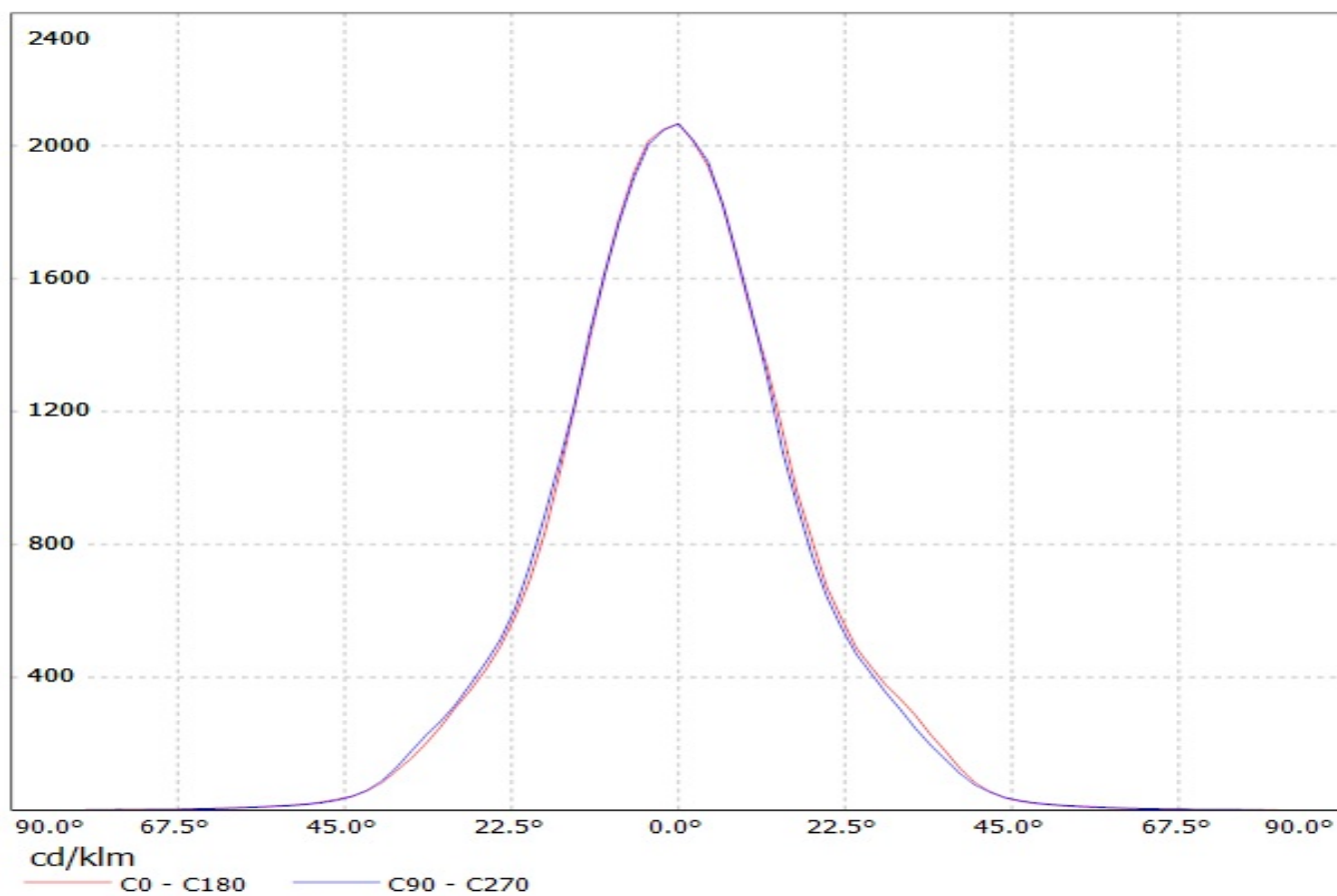

Luminaire: LEDiL Oy CN13131_MIRELLA-50-M-DL-PF_(CXM-9)

Lamps: 1 x Luminus_XNOVA_CXM-9_(AA00)_974.297lm@240mA_P=8.2836W_I=240mA

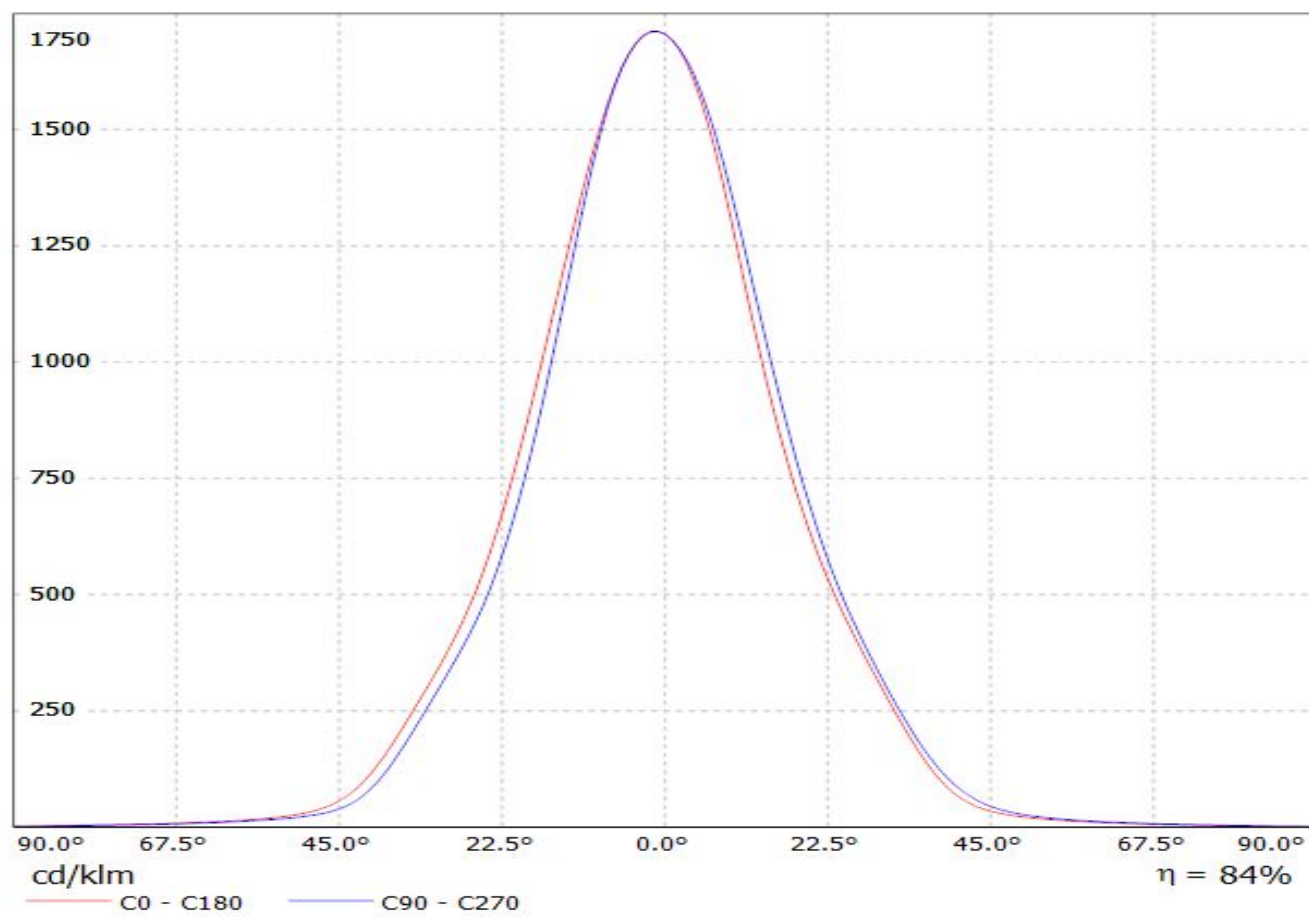

Luminaire: Ledil Oy CN13131_MIRELLA-50-M-DL-PF_(Soleriq_S9)_SIMULATED
Lamps: 1 x Osram Soleriq S9 (GW KAJFB3.EM)

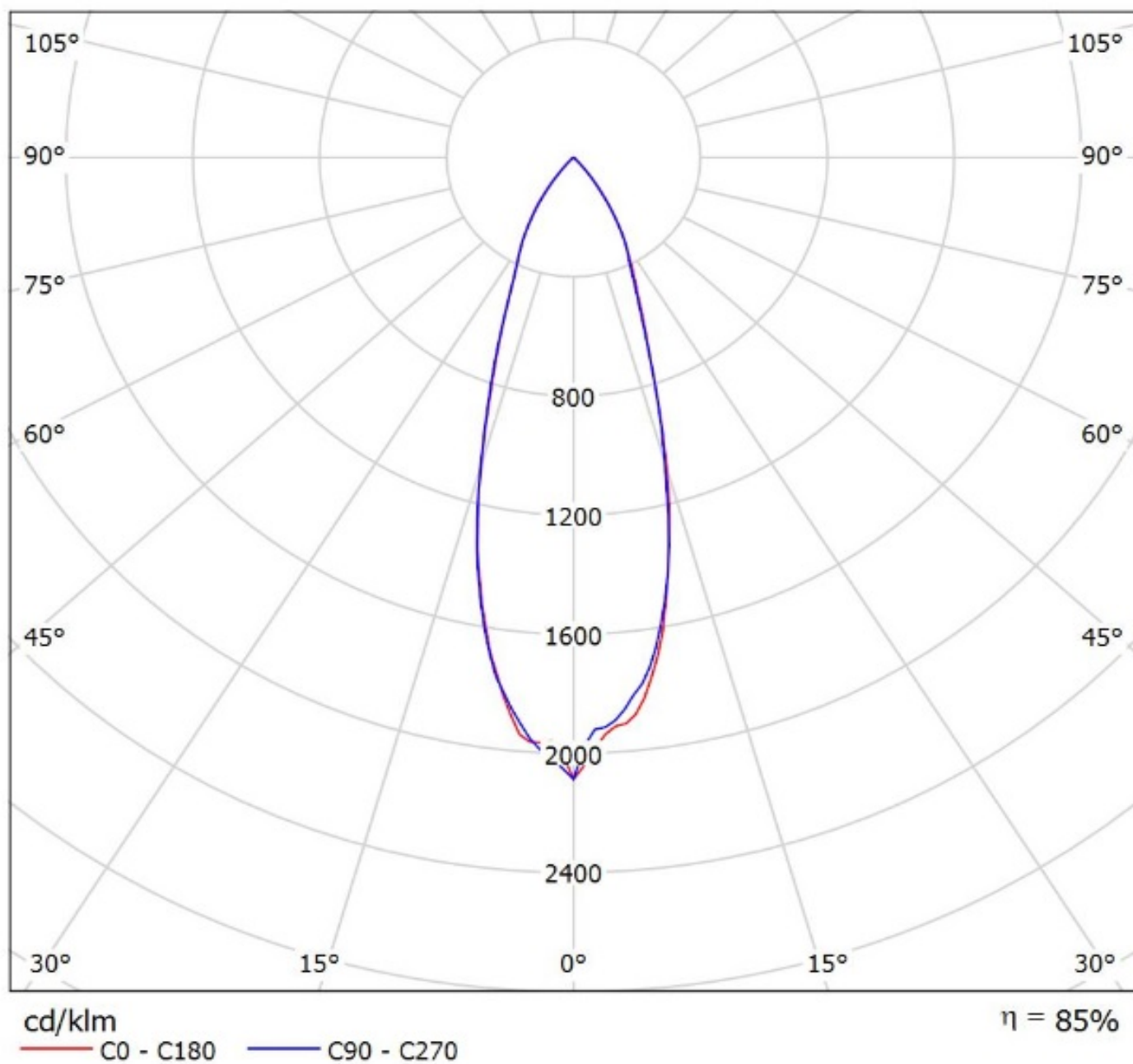

Luminaire: LEDiL Oy CN13131_MIRELLA-50-M-DL-PF_(MK-R) Eff.80.2%
Lamps: 1 x CREE_MK-R_358.348lm@250mA_P=2.84311W_I=249.9mA

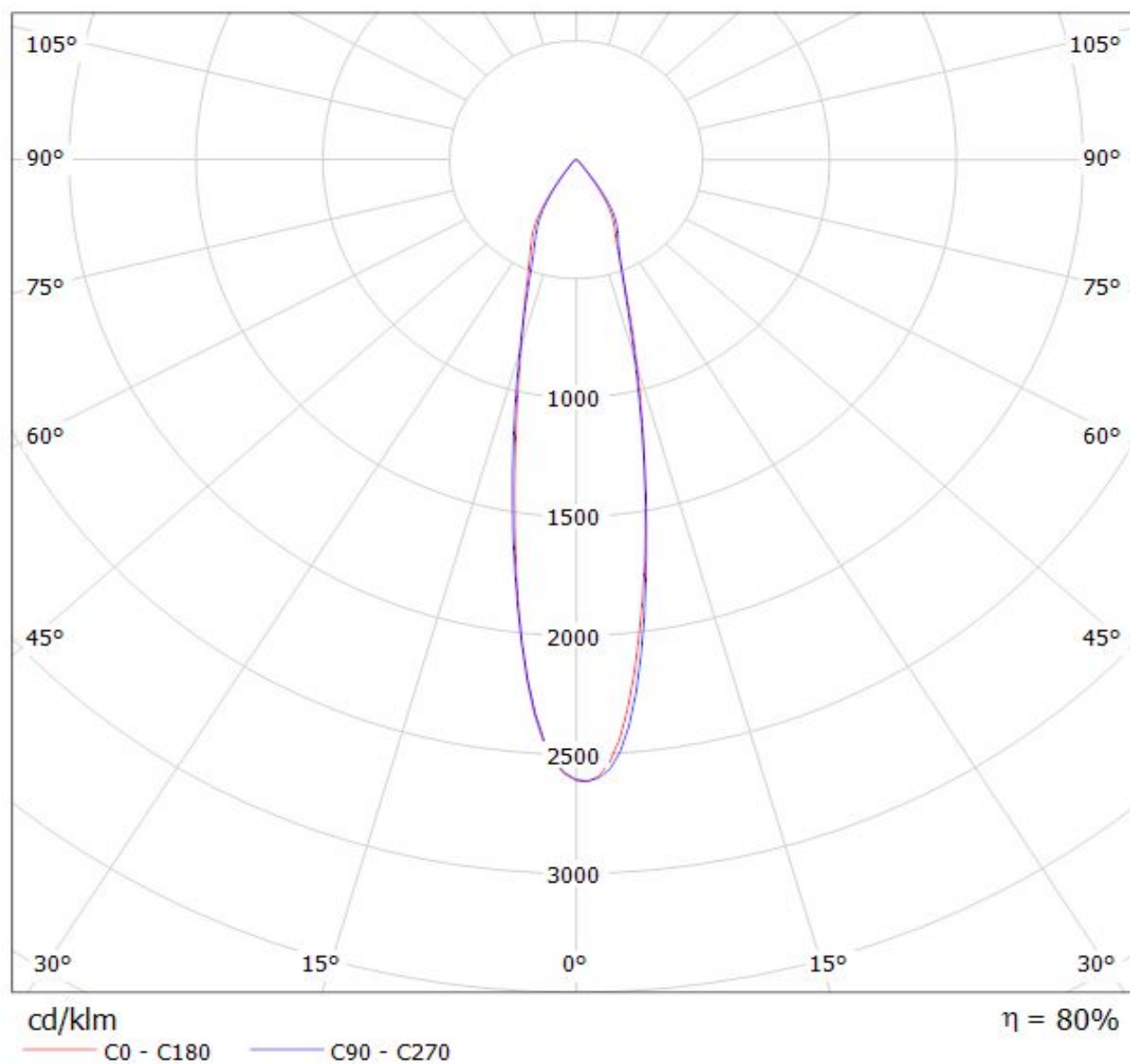

Luminaire: LEDiL Oy CN13131_MIRELLA-50-M-DL-PF_(CREE_XHP50_WARM_WHITE)
Lamps: 1 x CREE_XHP50_WARM_WHITE_194.142lm@250mA_P=1.39939W_I=0.2499A

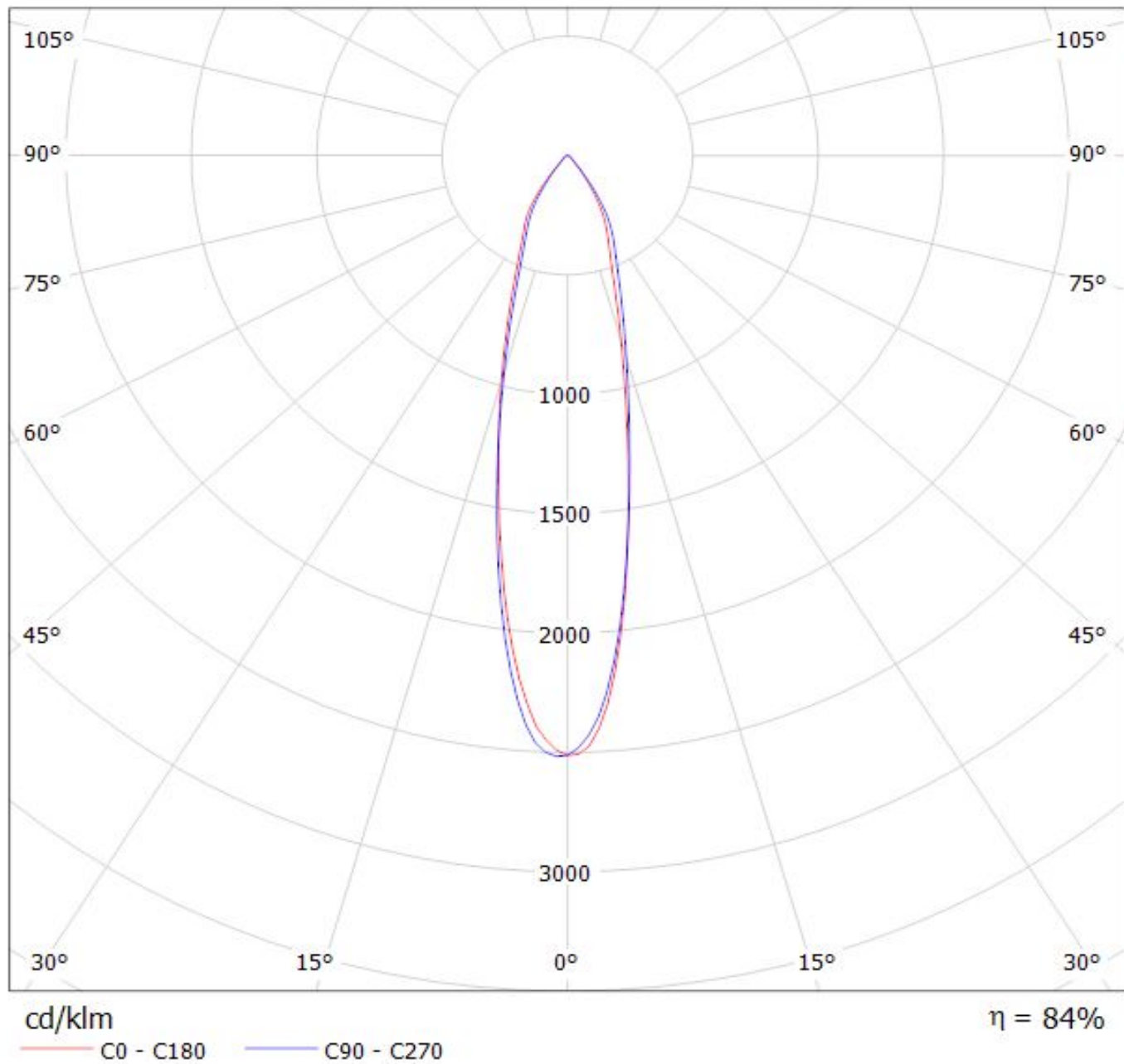

Luminaire: LEDiL Oy CN13131_MIRELLA-50-M-DL-PF_(CLU700)

Lamps: 1 x Citizen_CLU700_C13083_PF-SOCKET_394.785lm@100mA_P=2.92999W_I=0.1044A

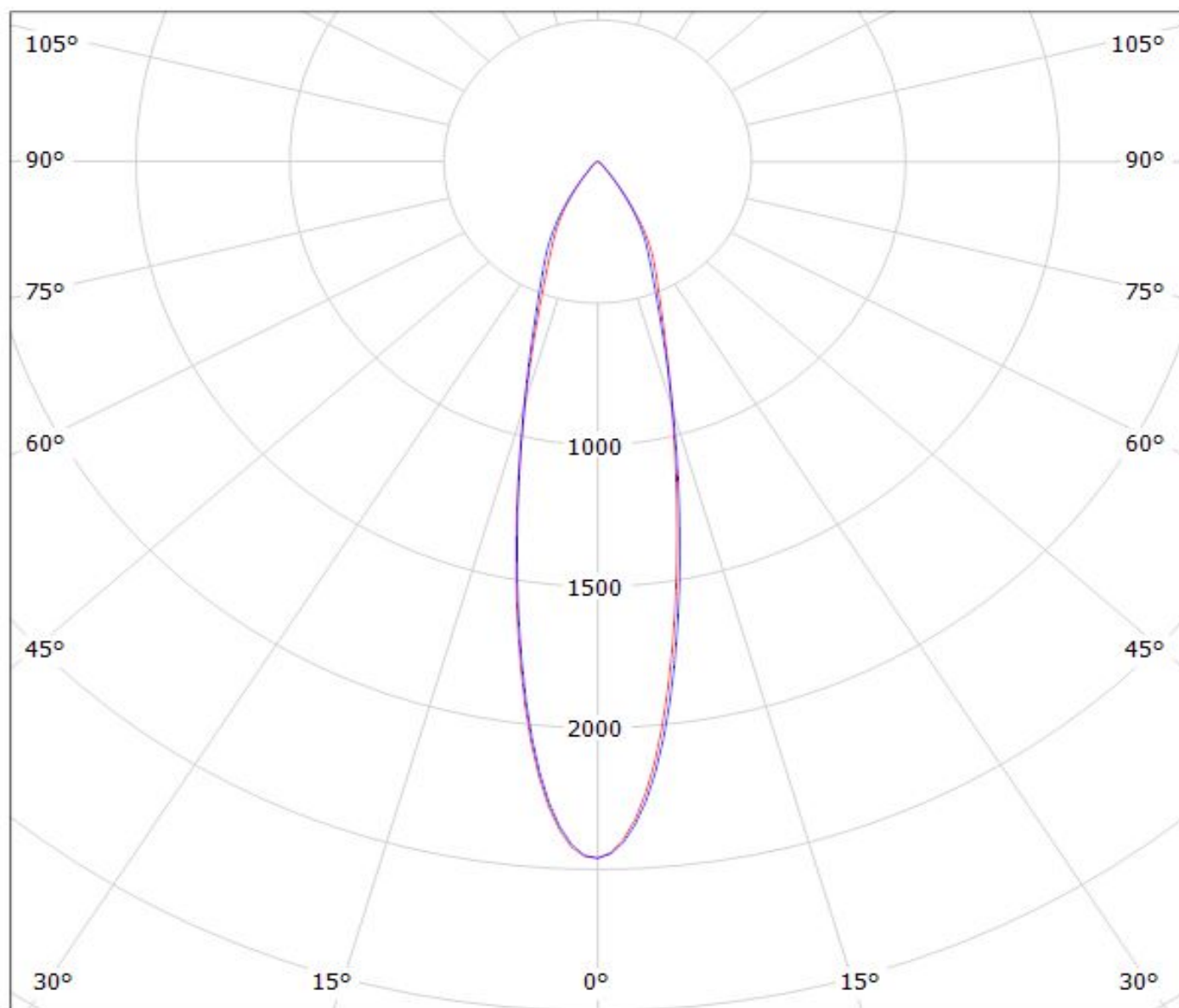

cd/klm

$\eta = 81\%$

C0 - C180

C90 - C270

Luminaire: LEDiL Oy CN13131_MIRELLA-50-M-DL-PF_(CREE_XHP70)
Lamps: 1 x CREE_XHP70_260.212lm@250mA_P=1.383W_I=0.2499A

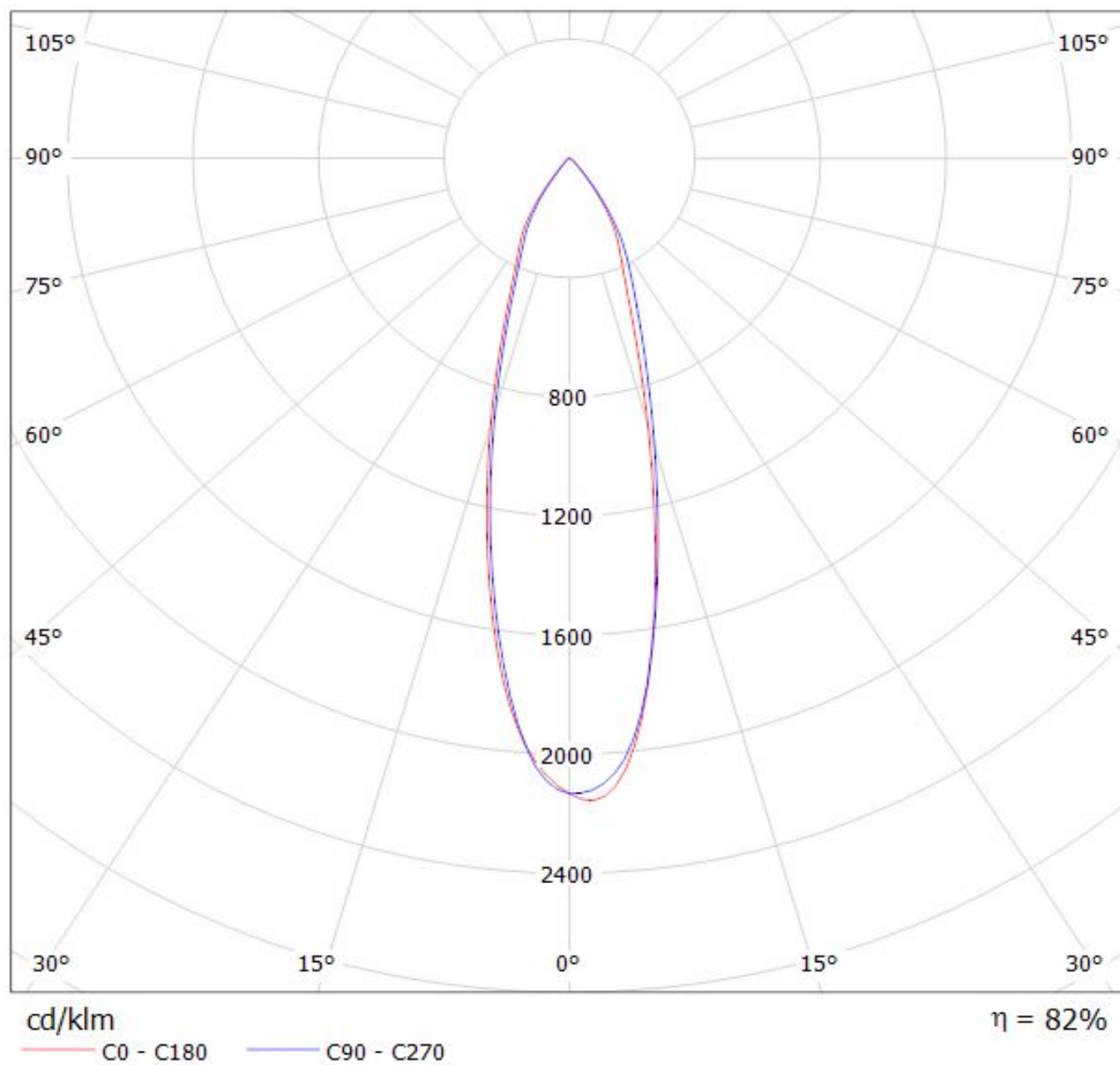

Luminaire: Ledil CN13131_MIRELLA-50-M-DL-PF_(MHD-G)
Lamps: 1 x Cree MHD-G_530.44lm@100mA_P=3.0W_I=0.100A

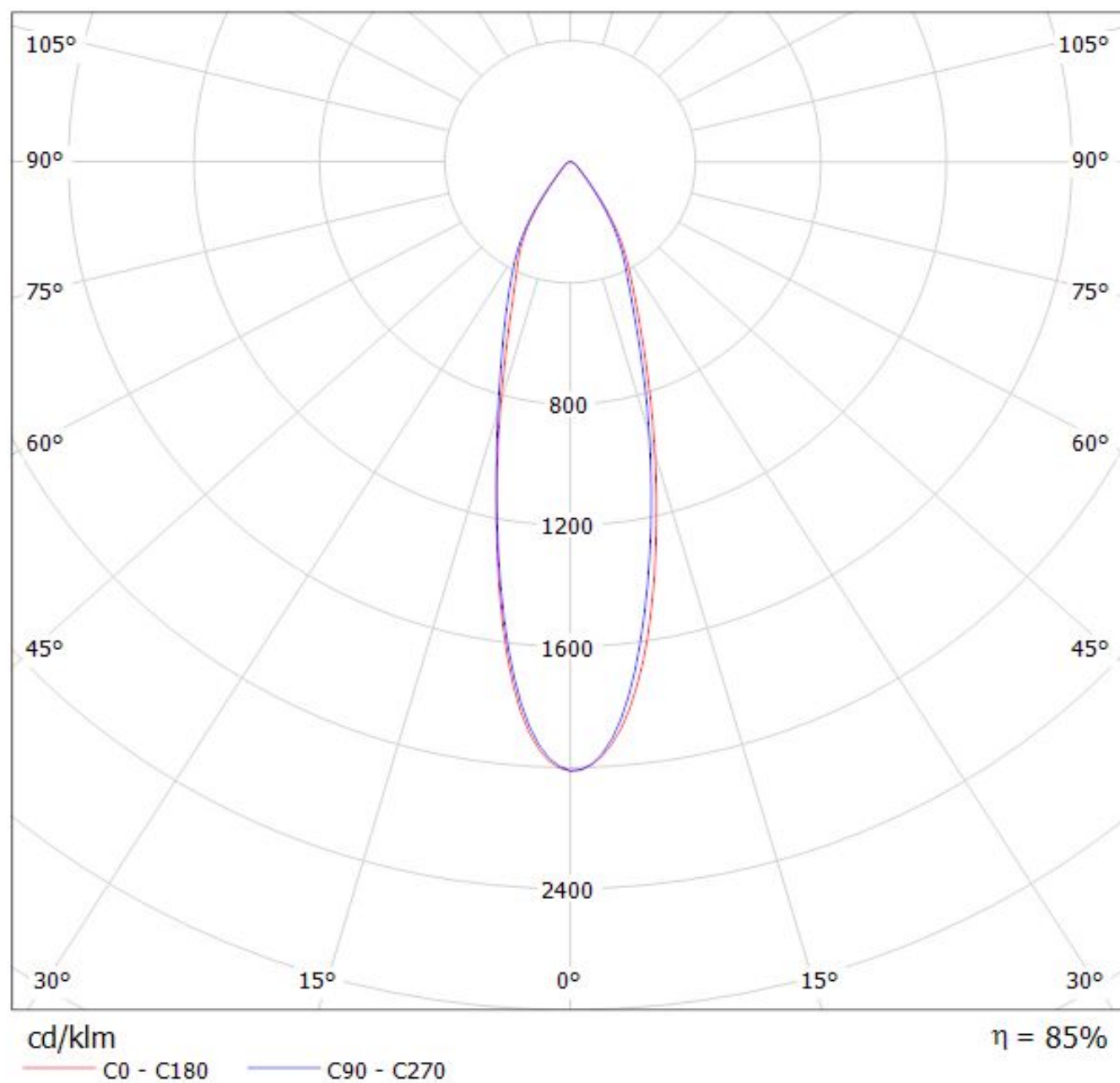

Luminaire: LEDiL Oy CN13131_MIRELLA-50-M-DL-PF_(Mini_Zenigata_GW6BM) Eff.83.3%
Lamps: 1 x Mini_Zenigata_GW6BM (803.772lm@250mA)

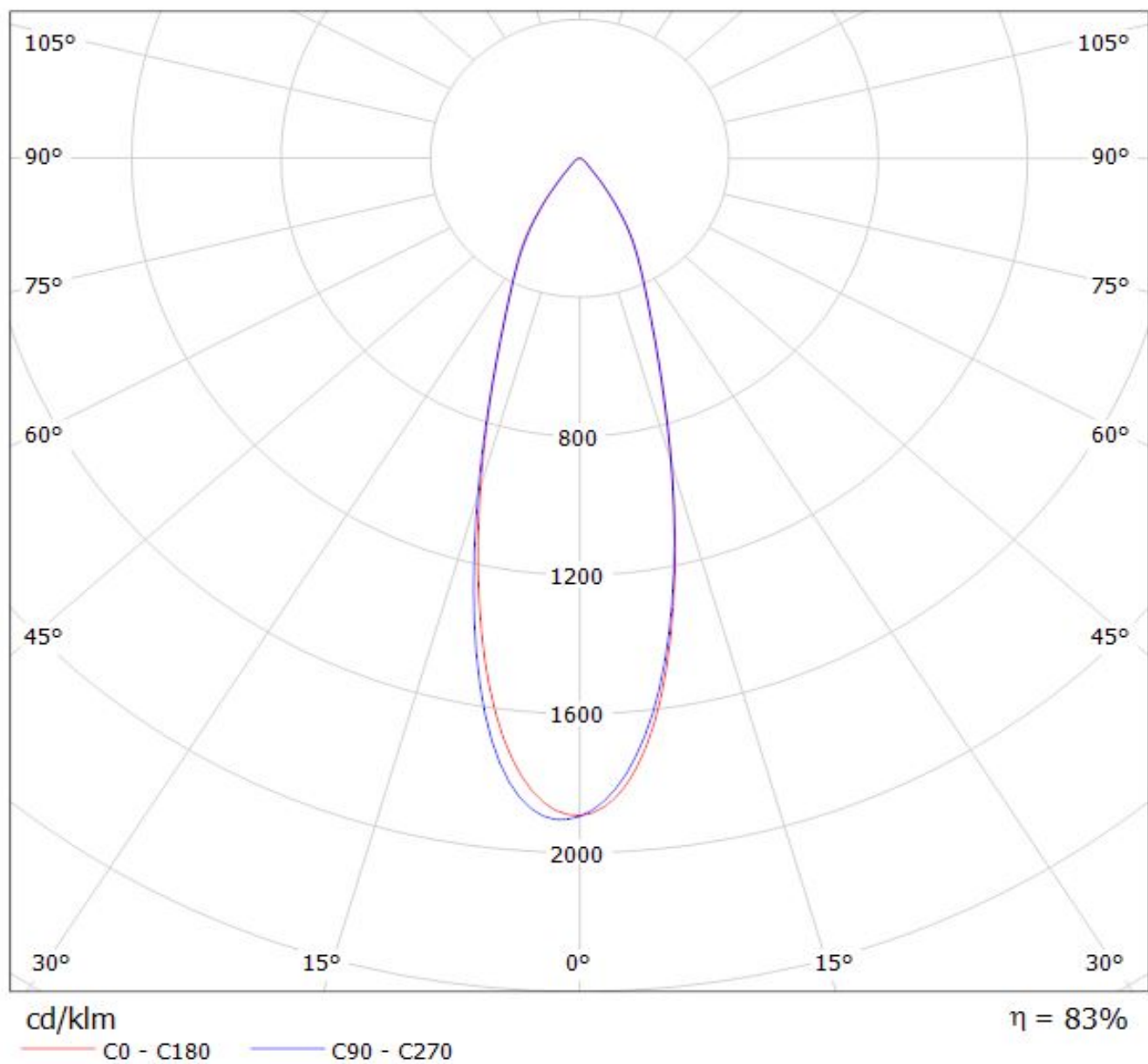

Luminaire: LEDil Oy CN13131_MIRELLA-50-M-DL-PF_(ZC6) Efficiency=83%
Lamps: 1 x Seoul ZC6 (SDW81F1C) 422lm @ 100mA CCT=3100K P=3.4W I=100mA

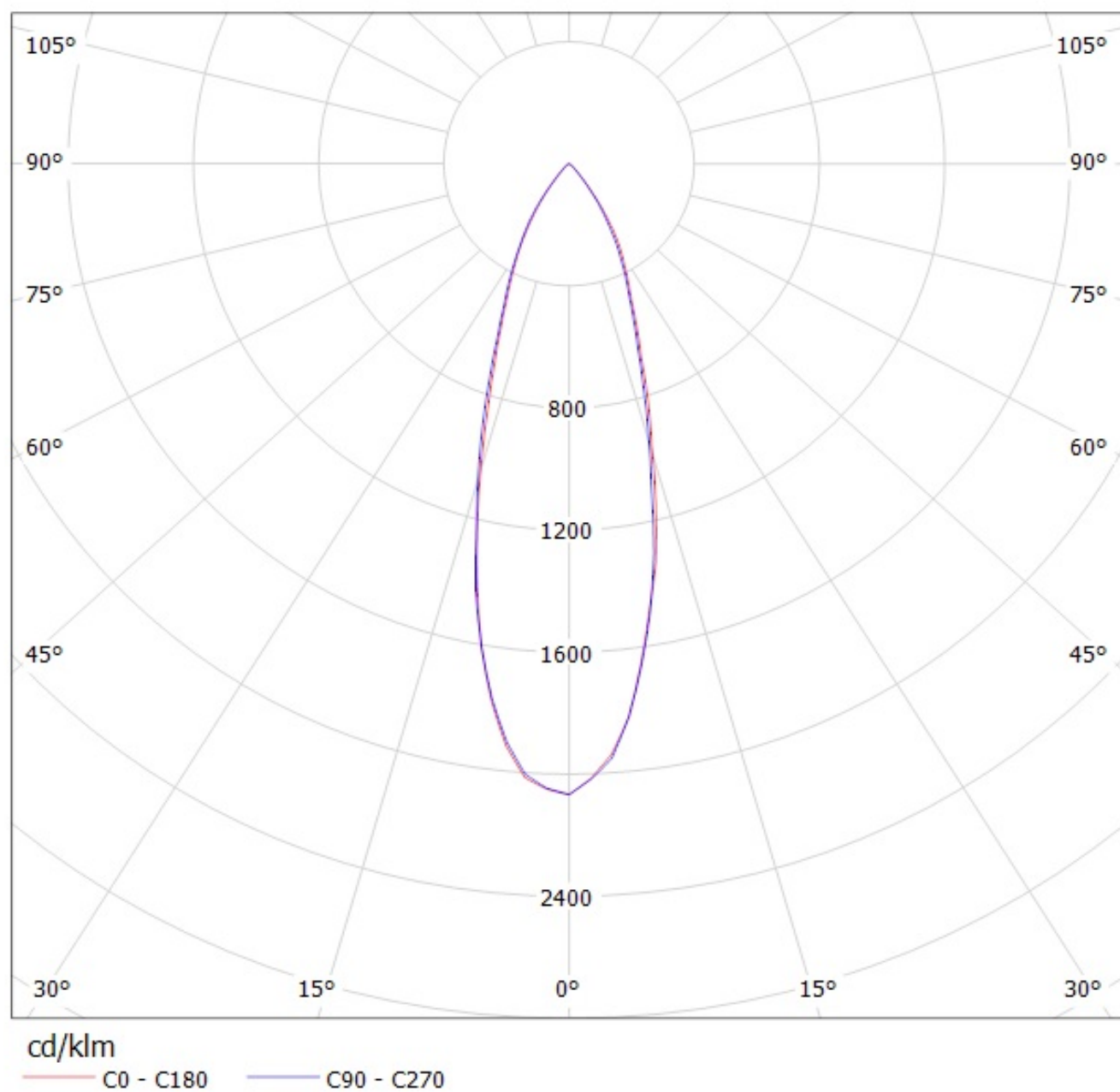

Luminaire: LEDiL Oy CN13131_MIRELLA-50-M-DL-PF_(CXM-9)
Lamps: 1 x Luminus_XNOVA_CXM-9_(AA00)_974.297lm@240mA_P=8.2836W_I=240mA

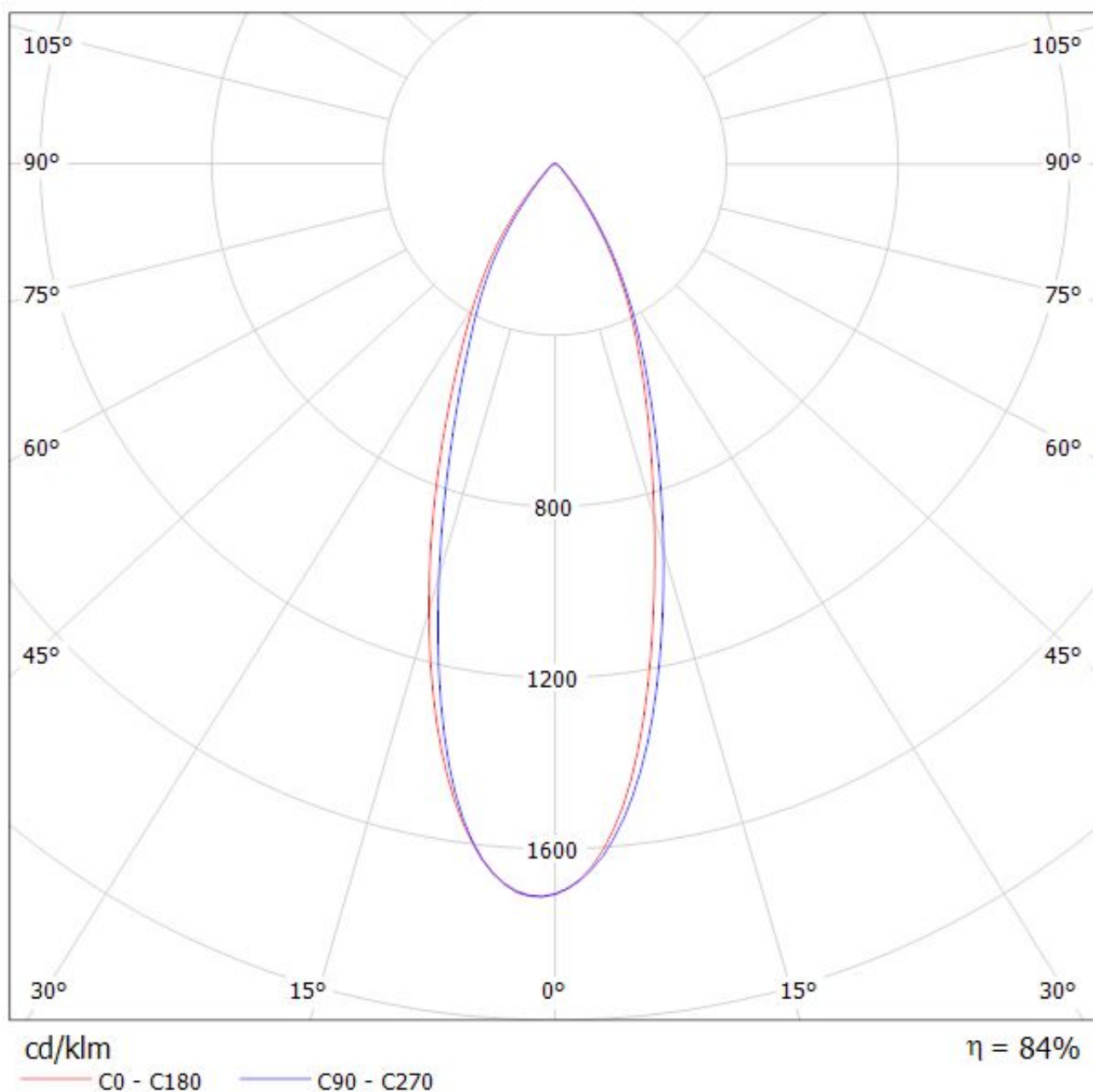

NOTE: The typical divergence will be changed by different color, chip size and chip position tolerance. The typical total divergence is the full angle measured where the luminous intensity is half of the peak value.

GENERAL INFORMATION

- Product series especially designed & optimized for series of LEDs.
- Special care taken to make light distribution as uniform as possible.

Note! Due to use of high power COB's with this product, special attention to proper thermal design is highly recommended. LEDiL has no liability for direct, indirect or consecutive damages arising from the LEDiL products being used outside of the recommended temperature range.