

SXO-6000L(T)

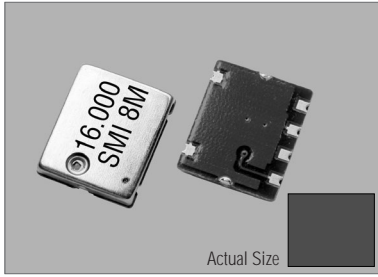

SXO-6000L(TV)

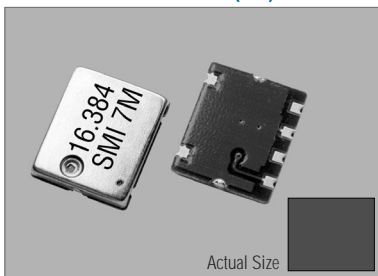

SXO-6000L

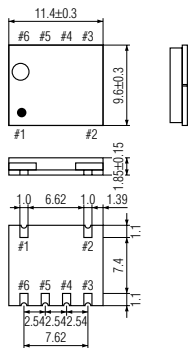

PIN	CONNECTION	
	SXO-6000LT	SXO-6000LTV
1	GND	GND
2	GND	GND
3	OUTPUT	OUTPUT
4	GND	GND
5	N.C.	Vcon
6	+V DC	+V DC

SOLDERING PATTERN

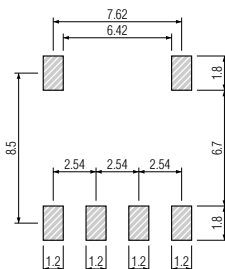

STANDARD SPECIFICATIONS

Item	Specifications	
	SXO-6000L(T)	SXO-6000L(TV)
Generic part number	SXO-6000L(T)	SXO-6000L(TV)
Frequency range	9.600000 MHz to 40.000000 MHz	
Initial frequency tolerance	±0.5 ppm max. (Vcon = 1/2VDD DC at +25°C ±2°C)	
Frequency stability	BB/i/ii : ±1.0 ppm over -20°C to +70°C (referred to +25°C) EE/k/jj : ±2.5 ppm over -30°C to +75°C (referred to +25°C) EE/m/ll : ±2.5 ppm over -40°C to +85°C (referred to +25°C)	
Temperature range	Input voltage change Output load change Aging	
Input voltage change	±0.3* ppm max. at VDD ±5% DC	
Output load change	±0.3* ppm max. at 10K Ω ±10% with 10 pF ±10%	
Aging	±1.0* ppm max. / year at +25°C ±3°C	
Absolute Max. Ratings	Supply voltage: 0V to +7.0V Control voltage (Vcon): n.a. / 0.3V to VDD +0.6V Storage temperature: -40°C to +85°C	
Operating Conditions	Operating temperature: i/ii : -20°C to +70°C, k/jj : -30°C to +75°C, m/ll : -40°C to +85°C Input voltage (VDD) control voltage (Vcon): J = +3.0V, K = +3.3V, N = +5V DC ±5%	
Input current	n.a. / 1/2VDD ±1V DC (VDD = +3.0V or +3.3V) 1/2VDD ±2V DC (VDD = +5V)	
Output	Level: 1.5* mA max. (9.6 MHz to 16 MHz), 2.0 mA max. (16 MHz to 40 MHz) Load: 0.8* Vp-p min. (9.6 MHz to 16 MHz), 0.7Vp-p min. (16 MHz to 40 MHz) Waveform: 10K Ω // 10 pF, Clipped sine wave (DC-cut)	
Frequency Adjustment	Voltage control: n.a. Frequency slope: n.a. Internal trimmer: ±5* ppm to ±10* ppm (Vcon = 1/2VDD ±1V or ±2V) Positive	
SSB phase noise	±3 ppm min.	
Startup time	-140 dBc/Hz at 1 kHz offset	
IR reflow resistance	10 ms max.	
Reflow condition	±1.0 ppm max.	
Standard frequencies (MHz)	+250°C ±10°C for 10 seconds	
	10.000000 12.800000 13.000000 14.400000 15.360000 16.000000 19.200000 26.000000	

(※) Please contact about specifications for higher frequencies than 22MHz and input voltages of +3.3V & +5V.

PACKAGE DATA

Item	Package	SXO-6000L(T)	SXO-6000L(TV)
Cover		Metal	Metal
Base		PCB	PCB
Terminal		NiAu	NiAu
Terminal plating		Gold	Gold
RoHS		Compliant (Pb-free)	Compliant (Pb-free)

TAPE SPECIFICATIONS

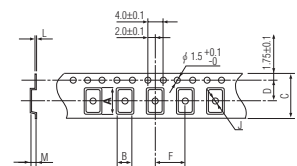

A	B	C	D	F	J	L	M	Reel Dia.	Qty/Reel
12.0	10.2	24.0	11.5	12.0	2.0	0.3	2.3	330 (300)	2000pcs